



Visit www.freshcoastguardians.com for how-to videos on rain barrel installation and other ways you can help protect Lake Michigan and other local waterways.



PAINTING YOUR BARREL

Interested in painting your rain barrel?

Visit us at: www.mmsd.com/what-we-do/green-infrastructure/rain-barrels/how-to-paint for lots of pictures and helpful tips.

Printed on recycled paper. 



CONTACT US

WEB www.freshcoastguardians.com/about-us/contact

PHONE (414) 225-2222

FOLLOW US   



19-041C2

DIVERTER RAIN BARREL CARE

Manage Water Where it Falls



INSTALLATION

See instructions inside the EarthMinded diverter kit

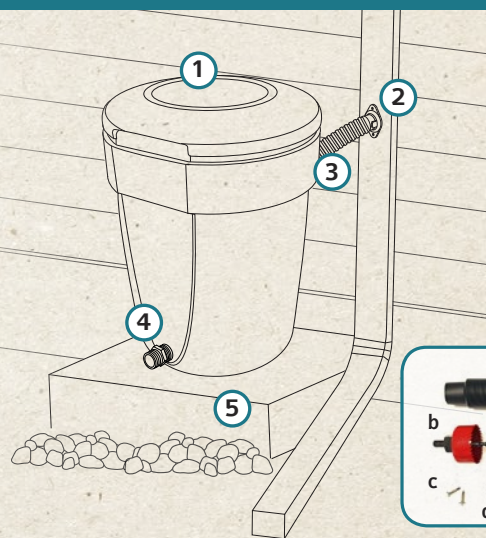

- ① Barrel
- ② FlexiFit™ Diverter
- ③ Fill Hose
- ④ Drain or Hose Attachment
- ⑤ Base

Diverter kit includes:

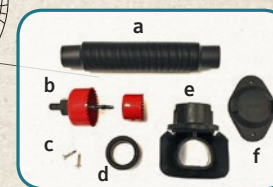

- a) Fill Hose
- b) Hole Saw
- c) Screws
- d) Rubber Seal
- e) FlexiFit™ Diverter
- f) Winterizing Hole Cover

Rain barrels capture rainwater from your roof to use later when it's dry outside to give thirsty gardens, flowers and trees a drink. Rain barrels help keep excess water out of the sewer system when it rains. They also help prevent rain from becoming polluted stormwater runoff—the biggest remaining threat to clean rivers and lakes in the United States.

INSTALLATION TIPS

- If your roof or gutters are in need of repair, **do not** install rain barrel until repairs are complete.
- Level the rain barrel by adding crushed gravel and compacting it down with a tamper or cinder block before adding the base.
- Measure your downspout before installing the FlexiFit Diverter:
 - If you have a 2x3 downspout you will drill the hole and insert the FlexiFit Diverter in the front of the downspout
 - If you have a 3x4 downspout you will drill the hole and insert the FlexiFit Diverter on the side of the downspout
- Make sure the FlexiFit Diverter piece that is in the downspout is installed below the top of the rain barrel rim (without lid on)
- Elevate barrel on cinder blocks for increased pressure

✗ **WATER NOT FOR POTABLE USE**

MAINTENANCE

SPRING

- Hook your rain barrel back up (directions in diverter kit)
 - * Be sure rain barrel is level and diverter piece is below the top of the rain barrel
- Check the seals around the spigot and drain/hose attachment
 - * Additional pieces can be ordered online at www.rainbarrelparts.com
- Make sure your downspout is directed away from your house (minimum of 4', preferred 10')
- Check your gutters for debris
- Use the water in the rain barrel within 3 days, if possible

SUMMER

- Use the water in the rain barrel within 3 days, if possible
- Regularly check & remove debris from your gutters and FlexiFit™ Diverter

FALL

AT SEASON'S END (When temperature falls below 40°F):

- Remove leaves and empty the water out of the rain barrel
 - Remove leaves from the rain barrel by removing the lid
 - Spray the inside of the barrel with water and shake leaves out
- Remove the diverter piece from the downspout
- Secure winter cap over the hole in the downspout and screw into place
- Turn the rain barrel upside down and store in your garage or basement

WINTER

- Let your rain barrel hibernate